



APPLICATION

The EBB Design extractor fans are suitable for many domestic and commercial ventilation applications where higher system resistance pressures are encountered.

CONSTRUCTION

The EBB Design fans incorporate a forward curved centrifugal impeller.

MOTOR

The EBB Design fans are equipped with single-phase 230V, 50Hz, protected against electric shock Class II, degree of protection IP44.

HM and DV models are equipped with 2-speed motors.

Diagram of the electrical connection fig. 15 (model S), fig. 15, 19 (model M), fig. 17 (model T), fig. 1, 16, 19 (model HM), fig. 1 (model DV), p. 662-664.



WWW

DTR

CE



Backdraft shutter



Forward curved centrifugal impeller

MOUNTING POSITION

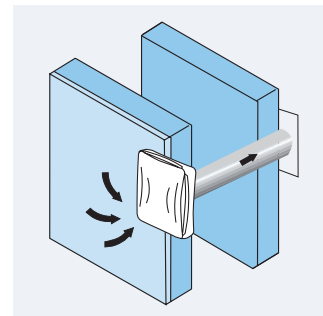
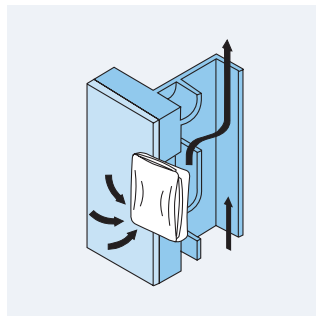
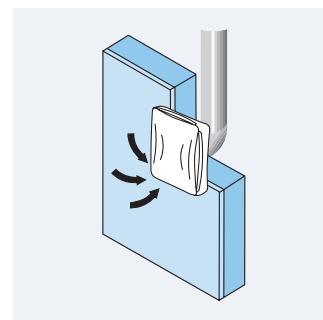
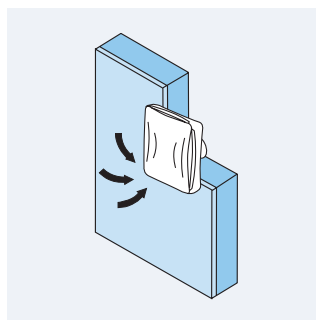

TECHNICAL CHARACTERISTICS

| Type | speed | speed | absorbed power at free discharge | voltage | airflow at free discharge | sound pressure level* | insulation class / IP | weight |
|----------------|-------|----------|----------------------------------|---------|---------------------------|-----------------------|-----------------------|--------|
| | | [r.p.m.] | [W] | [V] | [m ³ /h] | [dB(A)] | | [kg] |
| EBB-175 DESIGN | HS | 1250 | 26 | 230 | 155 | 41 | II / IP44 | 2,20 |
| | LS | 930 | 17 | | 80 | 33 | | |

* sound pressure level measured at 1,5 m at free air conditions.

MODEL FEATURES

| Type | S | M | T | HM |
|--|---|---|---|----|
| BALL BEARINGS | • | • | • | • |
| BACKDRAFT SHUTTER | • | • | • | • |
| ON/OFF PULL CORD SWITCH | | • | | • |
| ONE SPEED MOTOR | • | • | • | |
| TWO SPEED MOTOR | | | | • |
| ADJUSTABLE RUN-ON-TIMER (from 1 to 30 min) | | | • | |

PERFORMANCE CURVES

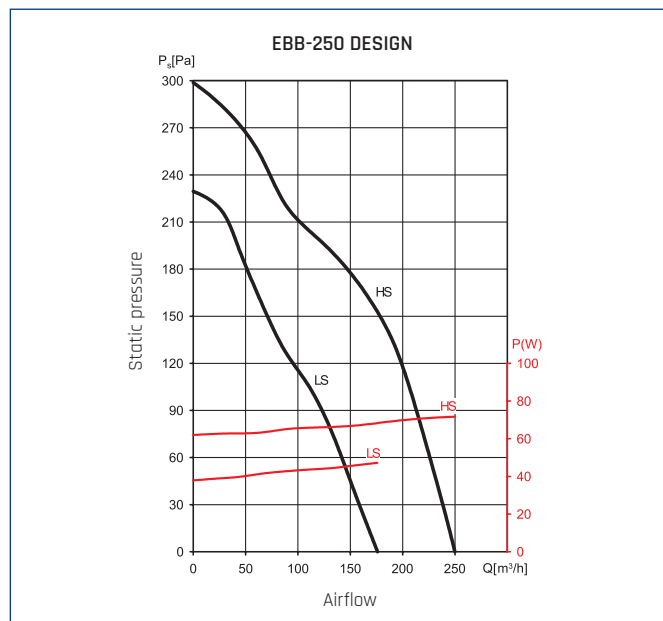
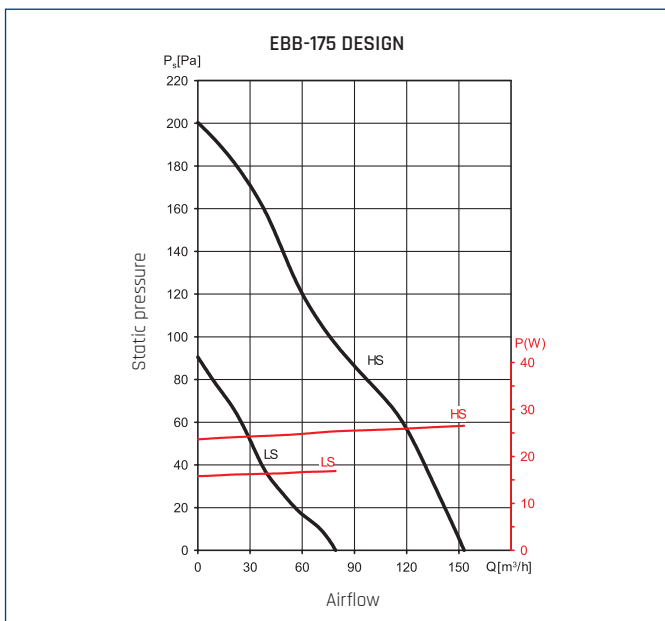

* 2-speed motors only from HM and DV models.

DIMENSIONS [mm]

